

## Centrifugal Fans

### FEATURES

The centrifugal impellers offers the high static pressure required for long duct applications. The backward curved centrifugal impeller also offers low noise operation.

The casing is constructed of galvanised sheet steel, that offers years of durability with anti-corrosion benefits at low cost.

### ADVANTAGES

The resulting advantages are :

- \*High static pressure
- \*Easy installation and maintenance
- \*Low noise
- \*Non-overloading and medium pressure stability
- \*High efficiency

### MOTOR

The fan is driven by an efficient TEFC induction motor with IP55 protection. These motors are flanged-mounted to allow easy servicing. Class F electrical insulation together with precision bearings and special lithium-based grease, are offered as standard to prevent premature motor failure.

Purpose built motors; eg explosion-proof, high temperature, hazardous environment kitchen exhaust are available upon request.

All motors are optional for 100% speed controllable using frequency speed controllers.

### FAN UNIT

Light-weight aluminium impellers, which has non-overloading characteristic are used in the construction. The fan impeller is statically and dynamically balanced to ensure a vibration free operation.

WE ARE:

**DESIGNERS** with form and function in mind, and excel in efficiency

**MANUFACTURERS** offering a high standard of quality, utilising economical premium materials

**TESTERS** with fully accredited superior in-house facilities to attain high levels of accuracy and an aptitude for investigative knowledge

With 20 years of experience behind us, we pride ourselves in technology with service and support



# Centrifugal fans

## FAN PERFORMANCE CURVE

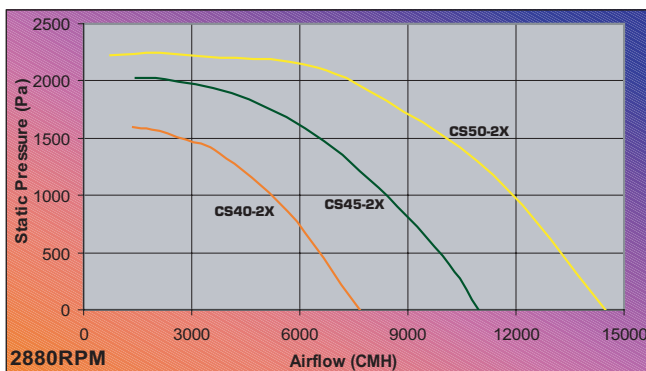
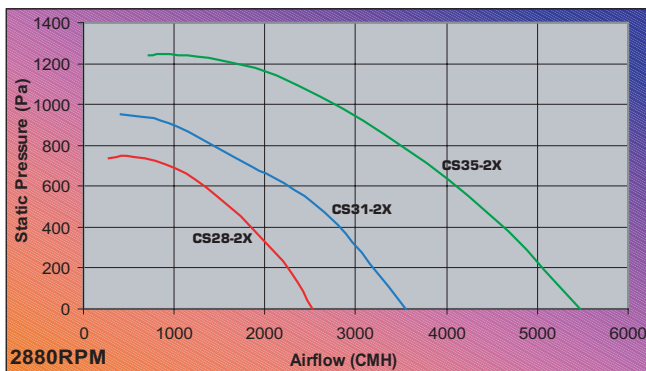
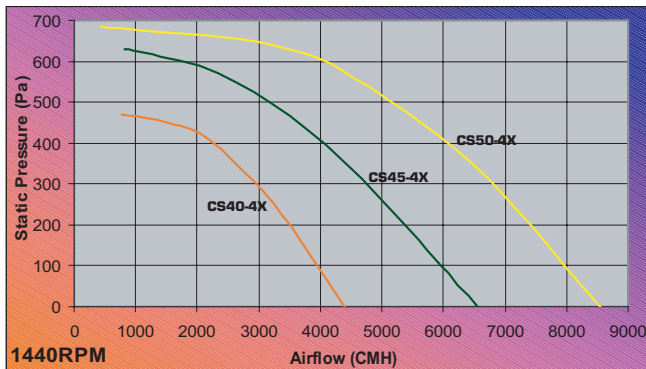
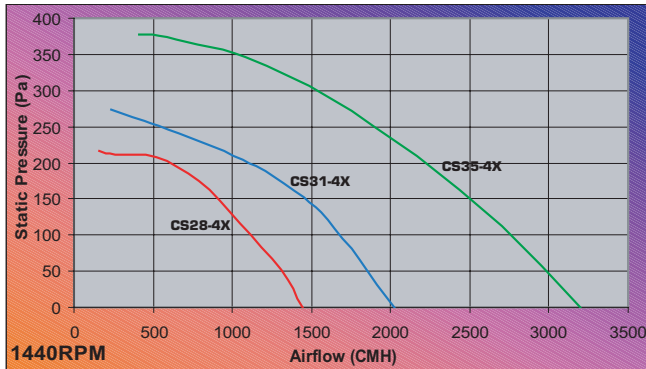

## SPECIFICATIONS

MODEL	RPM (min <sup>-1</sup> )	415Volts / 3 phase / 50 Hz			WEIGHT (kg)	SPL* (dBA @ 3.0m)
		RUNNING CURRENT (A)	STARTING CURRENT (A)	MOTOR POWER(kW)		
CS28-4X	1440	0.60	2.20	0.18	24	49
CS31-4X	1440	1.10	4.20	0.37	29	51
CS35-4X	1440	1.10	4.20	0.37	30	53
CS40-4X	1440	1.60	7.00	0.55	38	58
CS45-4X	1440	3.00	15.10	1.10	49	61
CS50-4X	1440	3.80	20.50	1.50	63	66
CS28-2X	2880	1.83	10.20	0.75	26	70
CS31-2X	2880	3.50	22.10	1.50	32	73
CS35-2X	2880	4.90	31.40	2.20	40	76
CS40-2X	2880	4.90	31.40	2.20	41	82
CS45-2X	2880	6.40	45.10	3.00	53	89
CS50-2X	2880	8.10	55.80	4.00	62	96

\* The noise level must be taken only as a guide as site conditions, directivity, absorption and reflectiveness of adjacent surface can combine to affect the overall resultant noise level.

## DIMENSIONS

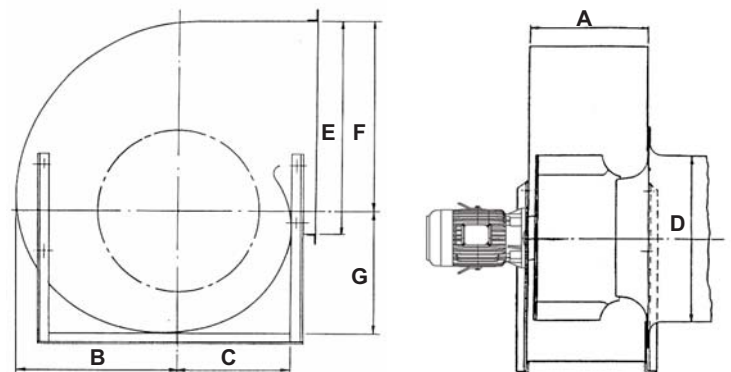

DIMENSION	MODEL					
	CS28	CS31	CS35	CS40	CS45	CS50
A	180	205	245	280	310	345
B	248	279	314	354	398	442
C	178	200	226	255	287	319
D	280	310	355	400	450	500
E	355	400	450	500	560	630
F	302	339	383	431	485	538
G	205	231	260	293	330	367